

Category 6A Shielded XLR Plug



Category 6A Shielded XLR plug (PGSDBk)

This Category 6A XLR STP plug is die-cast and ruggedised. IP66 rated, it is built to be used in a wide range of challenging environments. Using the industry standard, XLR latch-locking mechanism, it offers a secure connection that comfortably performs to Cat6A.

Features

- Category 6A shielded XLR style plug
- Ruggedized connector with CAT6A component compliance according to ISO / IEC 11801 and TIA / EIA 568-C.2
- PoE++ compliant according to 802.3bt Type4
- Ideal for field termination but also suitable for assembly operations
- Suitable for use with cables ranging from 4.5 - 8mm outer diameter (2 x retaining gaskets supplied for different size cable)
- Ideal for use in external environments such as outside broadcast, theatres, stadiums, and events.

Specifications

- Weight: 72 g approx.
- Dimensions: 80x80x30 mm
- Colour: Black
- Materials (housing):
 - Zn alloy+Nickel Plated
 - Impact-resistant,UV stabilized ABS+PC 94V0 plastic
 - Retaining gaskets – Silicone

- Materials (Plug)
 - RJ45 plug: housing: nickel-plated zinc-alloy
 - contacts: 50 μ "/1.27 μ m gold plating over phosphor bronze
 - plug cover: ABS, plug latch: POM
 - IDC: housing and cover: PC FR, terminals/contacts: tin-plated phosphor bronze
 - Earthing plate: SUS304

Packaging: Supplied in individual poly bags poly bags then in packs of 10

Commodity Code: 85177090

EAN: 5055386511515

Country of Origin: China

Component images:



Illustrative image:



Assembling the PGSDbk video

<https://youtu.be/IFJiWQ58m6c>

Instruction Manual

①

Remove the Cover Stopper before installation.

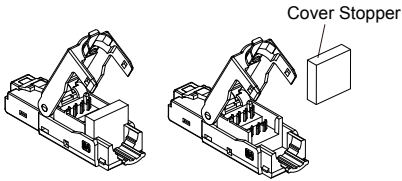

JACK PIN DESIGNATIONS	TIA / EIA T568A	TIA / EIA T568B	INDUSTRIAL
	1	White/Green	White/Orange
2	Green	Orange	Orange
3	White/Orange	White/Green	White
6	Orange	Green	Blue
4	Blue	Blue	
5	White/Blue	White/Blue	
7	White/Brown	White/Brown	
8	Brown	Brown	

②

Insert correct size silicone gasket and nut into cable, strip off 1.2 inch of cable jacket, fold back the earth wire.

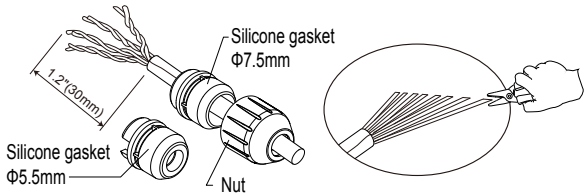

③

Fan out all four twisted pairs, following the colour coding label and allocate each conductor into proper slot on wiring cap. Trim excess conductors.

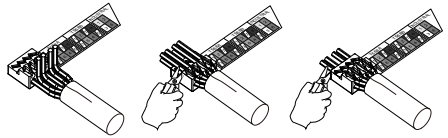

④

Remove the wiring label then place the wiring cap into plug.

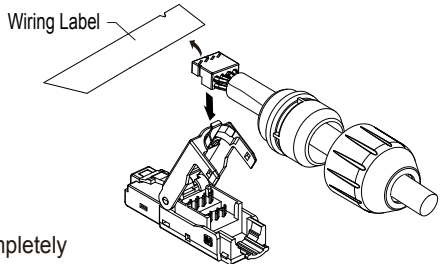

⑤

Use plier to clamp wiring cap until it completely snap-in to effect the connection.

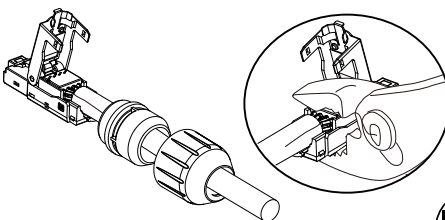

Instruction Manual

⑥

Close plug cover, make sure the earth wire is in proper contact with earthing clip on plug. Fasten cable tie to secure earth contact.

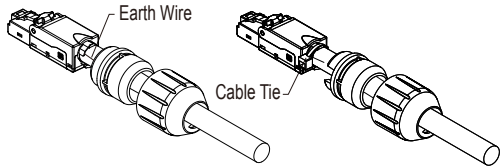

⑦

- a Insert the plug into IP68 plug housing.
- b Push silicone gasket near to the plug, turn the indentation slot of the silicone gasket to align with cable tie.
- c Push nut near to silicone gasket.
- d Tighten nut onto IP68 plug housing.

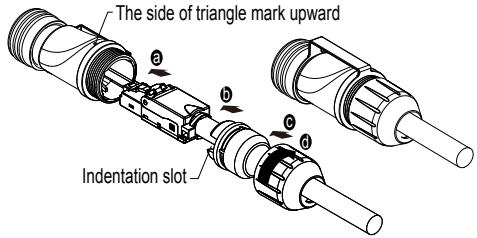

Remove cable from plug

Untighten nut from IP68 plug housing, pull back nut and silicone gasket.

Cut off cable tie, remove silicone gasket and nut. Using flat-head screw driver, and pry **gently** on plug cover, one side then the other side, to open it.

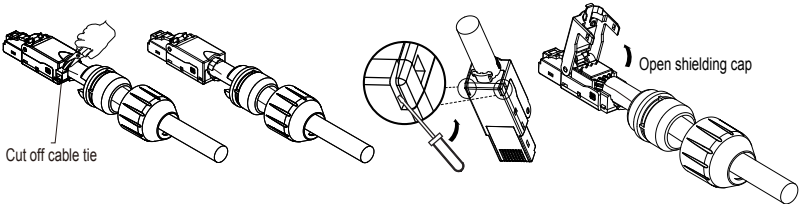

ROHS Compliant

Code: PGSDbk

HOUSING

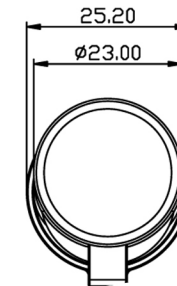
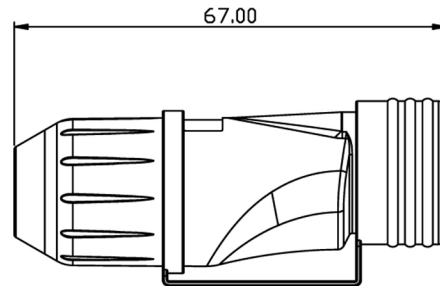
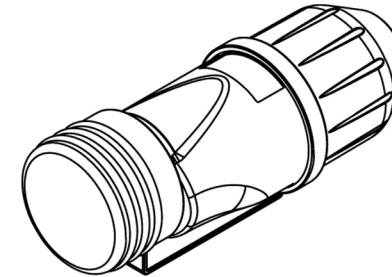
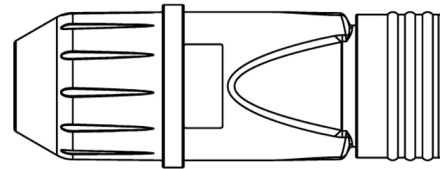

Silicon Gaskets

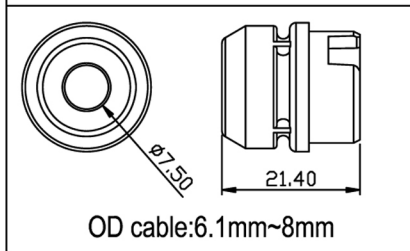
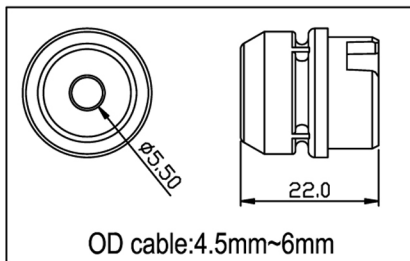
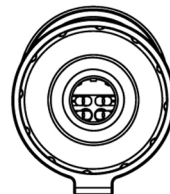

PLUG

